

DRIVELINE QUICK REFERENCE GUIDE

MERITOR DRIVELINE

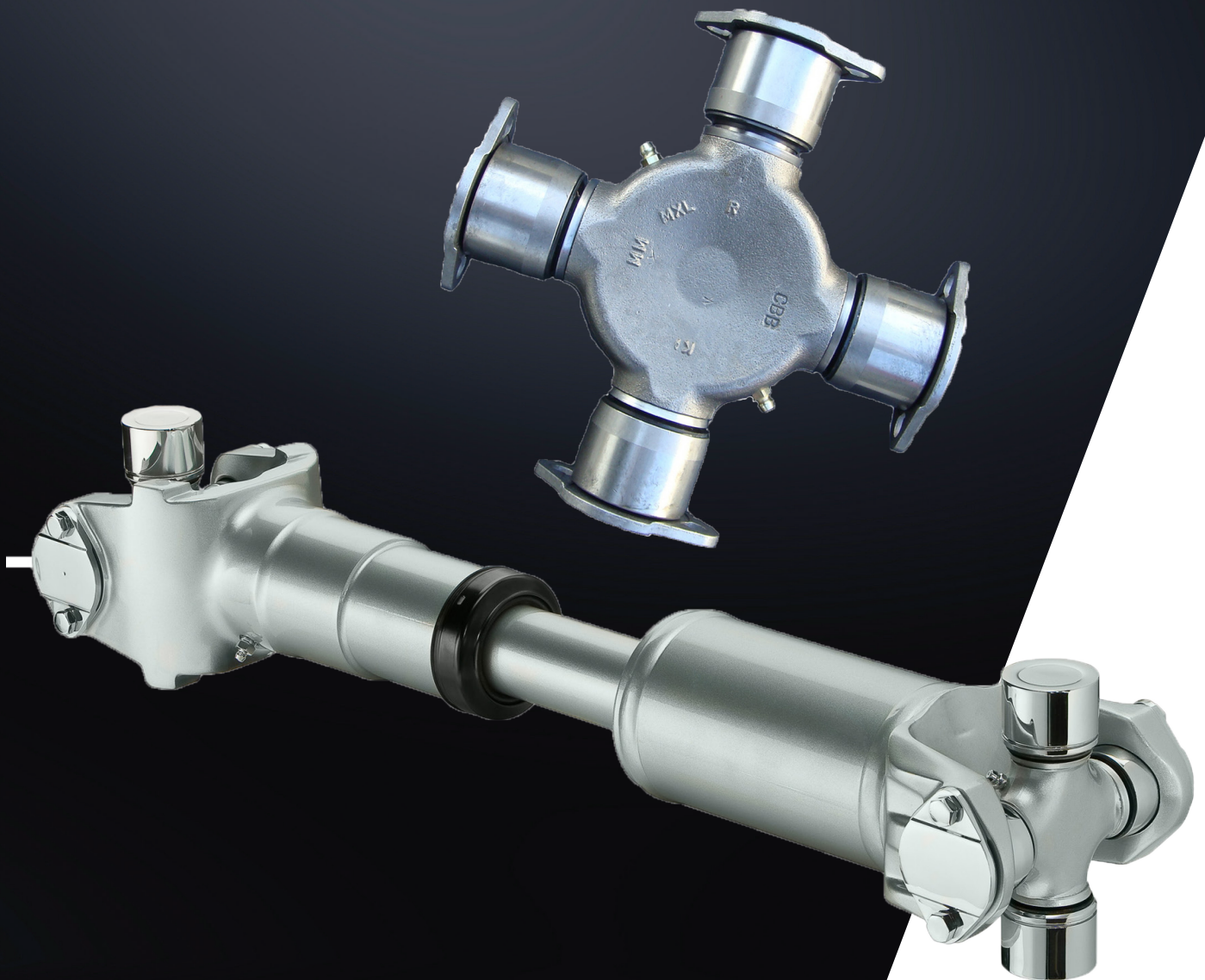

Meritor

**FOR
A WORLD
THAT'S
ALWAYS ON™**

IMPORTANT INFORMATION

DISCLAIMER

Information contained in this publication is in effect at the time the publication was approved for printing and is subject to change without notice or liability. Meritor, reserves the right to revise the information presented or discontinue the production of parts described at any time.

Manufacturers names, part numbers, symbols or other references appearing in this catalogue are used for reference for order of goods only. Images are also for reference only and not to scale.

COPYRIGHT

All rights reserved. The Meritor or any part or layout of the catalogue cannot be printed or reproduced without written authorisation from Meritor.



Found an error?

If you detect any errors in this catalogue, please let us know. We want to ensure the information we publish is as accurate as possible. We appreciate your help in making this happen.

Please forward your enquiries to:

Email: cvaau.sales@Meritor.com

Phone: (03) 8353 6050

INDEX

MERITOR® DRIVELINE QUICK REFERENCE GUIDE

Intro - MXL Construction / Centre Bearings / Slip Yokes.....	2
Meritor Numbering System - Meritor Engineering & Aftermarket.....	3-10
1310 Series	11
1330 Series	11
1350 Series	12
1410 Series	12
1480 Series	12
1550 Series	12
1610 Series	13
1710 Series	13-15
1760 Series	16
1810 Series	16-17
SPL 170 Series	18
SPL 250 Series	18
RPL 20R Series.....	18
RPL 25R Series / Meritor RPL Option Yoke Reference / Transmissions	19
Centre Bearings.....	20
Universal Joints - Meritor.....	21
Universal Joints - Dana	22
Fast Moving Universal Joints.....	22
End Yokes Parts For Meritor Drive Axles	23
Driveline Components - Exploded View.....	24
Miscellaneous.....	25-26
Notes.....	27-28

QUICK REFERENCE FOR PART NUMBERS AND CORRESPONDING SERIES PREFIXES

Series	Parts Prefix
1310	131N
1330	133N
1350	135N
1410	141N
1480	148N
1550	155N
1610	16N
1710	17N
1760	176N
1810	18N
SPL 170	170N / 170TYS
SPL 250	250N / 250TYS
RPL 20R	20WYS
RPL 25R	25RY / 25WYS / 25RL / 25RPL

MXL U-JOINT CONSTRUCTION

MXL U- JOINTS - SOLID CONSTRUCTION INSIDE AND OUT

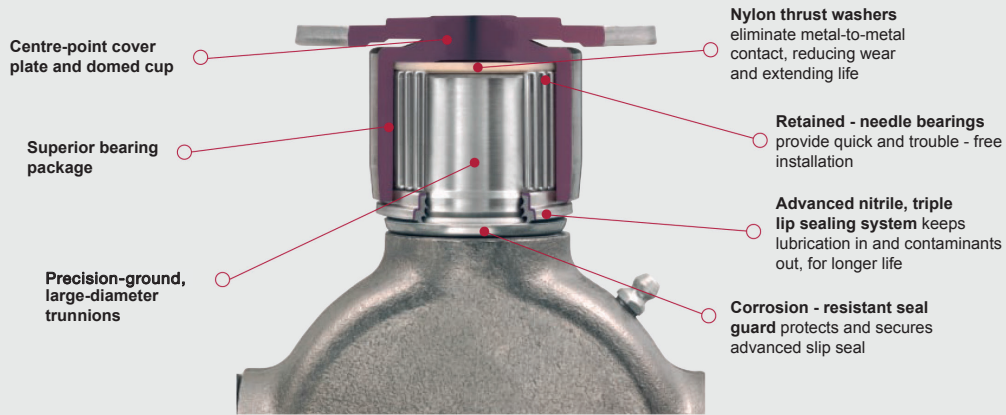

CENTRE BEARING - SELF ALIGNING

- Accommodates +/- 5-degree driveline angularity
- Sealed bearing with integral deflector shield and grease barrier protects the bearing against contamination without use of external deflectors

PART NUMBER	APPLICATION
CB210121-1XSA	17N
CB210661-1XSA	17N (Heavy -Duty), 176N & 18N - Slotted
CB210875-1XSA	17N (Heavy-Duty), 176N & 18N - Solid



SLIP YOKES

- Compatible With other industry-standard yokes
- Available With both easy-service and full-round yoke designs
- Completely interchangeable With most greasable drivelines
- Allows driveline standardisation regardless of vehicle make

PART NUMBER
17N-3-2401X-MXL
17N-3-2651X-MXL
17N-3-2671X-MXL
18N 3 1351X-MXL
18N 3 1371X MXL
18N 3 1431X MXL

PART NUMBER	SLIP & STUB ASSEMBLY
17NSLIP	17N 3 2651X MXL + 17N40521
18NSLIP	18N 3 1371X MXL + 18N40191



MERITOR NUMBERING SYSTEM

COMPANION FLANGES AND FLANGE YOKES

Meritor components may be identified by one of the numbering systems shown below. Aftermarket numbers are issued to make Meritor components easy to select when choosing a replacement component.

MERITOR ENGINEERING NUMBER

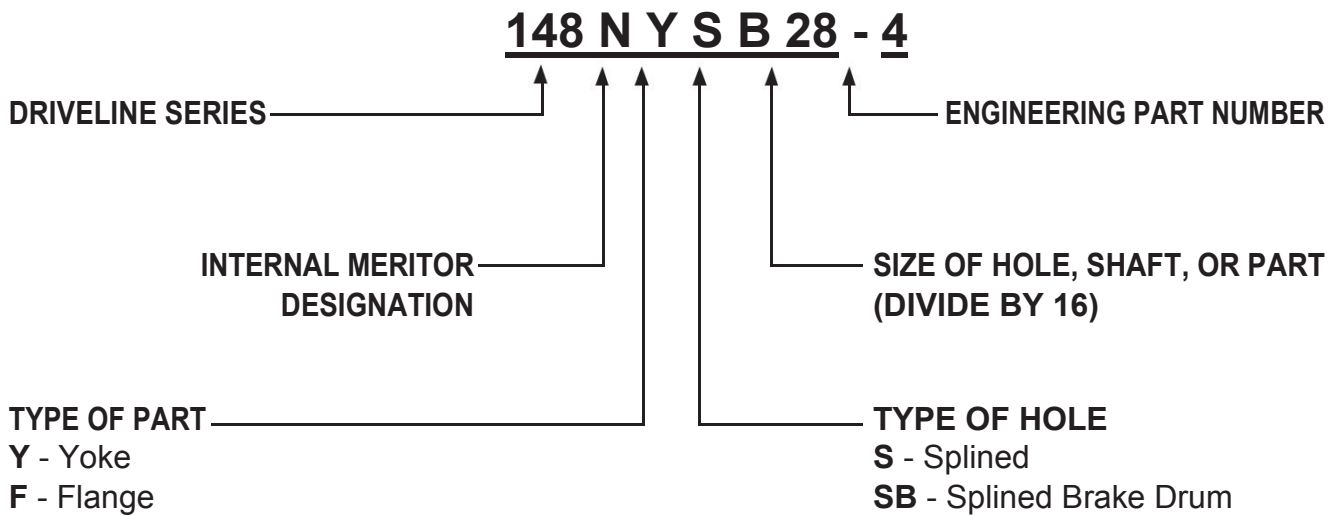

MERITOR AFTERMARKET NUMBER

MERITOR AFTERMARKET NUMBER

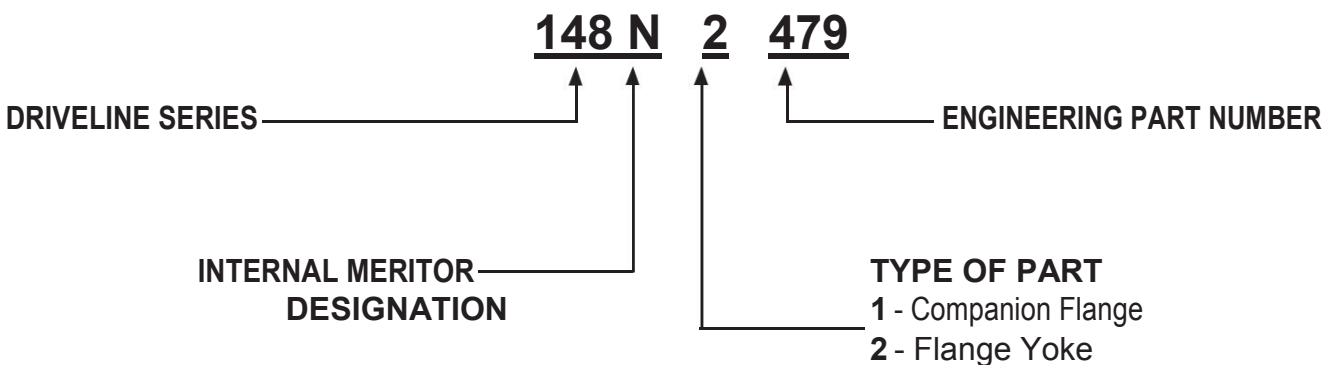

MERITOR NUMBERING SYSTEM

SLIP YOKES

Meritor components may be identified by one of the numbering systems shown below.

Aftermarket numbers are issued to make Meritor components easy to select when choosing a replacement component.

MERITOR ENGINEERING NUMBER

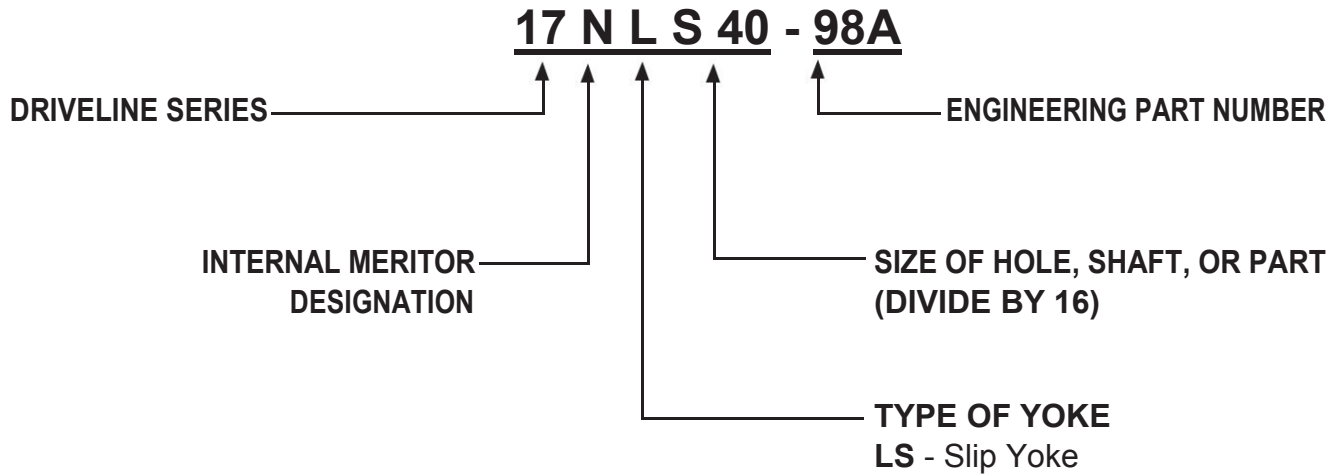

MERITOR AFTERMARKET NUMBER

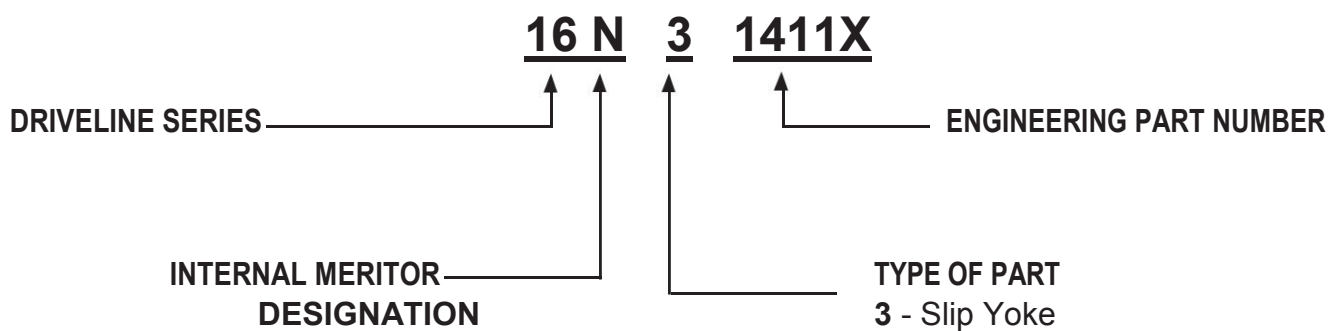

MERITOR NUMBERING SYSTEM

END YOKE - FULL ROUND

Meritor components may be identified by one of the numbering systems shown below.

Aftermarket numbers are issued to make Meritor components easy to select when choosing a replacement component.

MERITOR ENGINEERING NUMBER

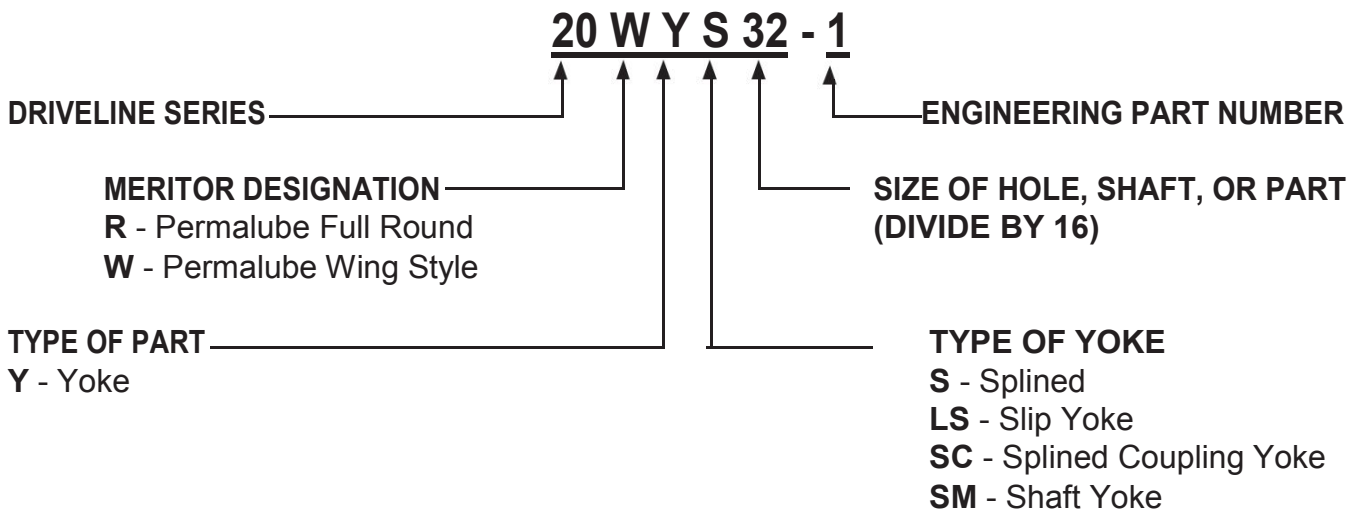
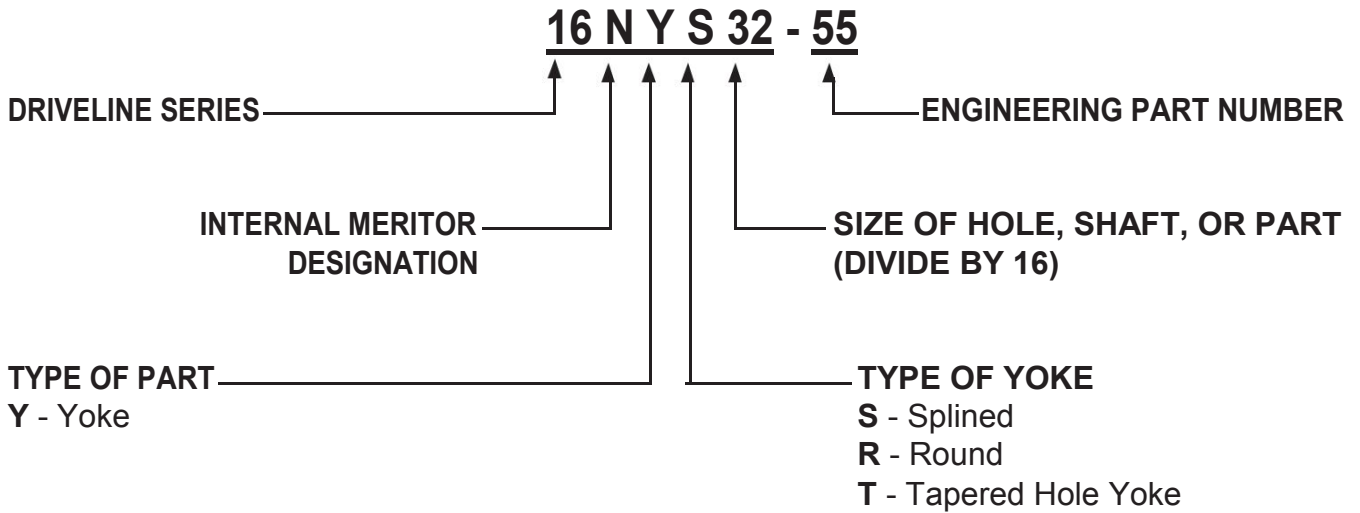

MERITOR AFTERMARKET NUMBER

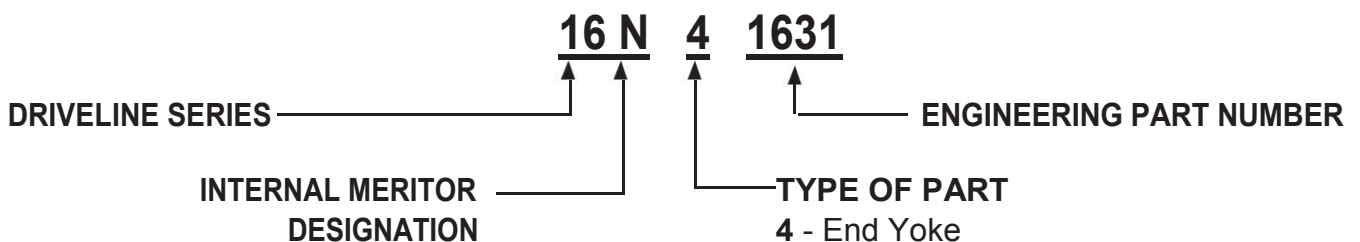

MERITOR NUMBERING SYSTEM

END YOKE - EASY SERVICE

Meritor components may be identified by one of the numbering systems shown below.

Aftermarket numbers are issued to make Meritor components easy to select when choosing a replacement component.

MERITOR ENGINEERING NUMBER

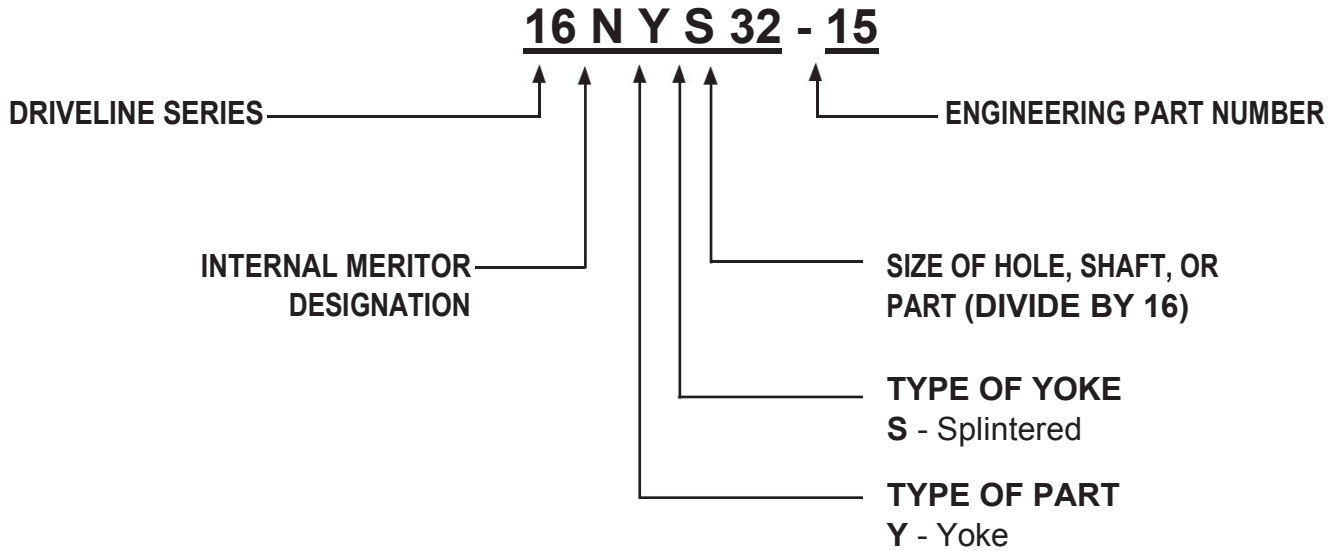

MERITOR AFTERMARKET NUMBER

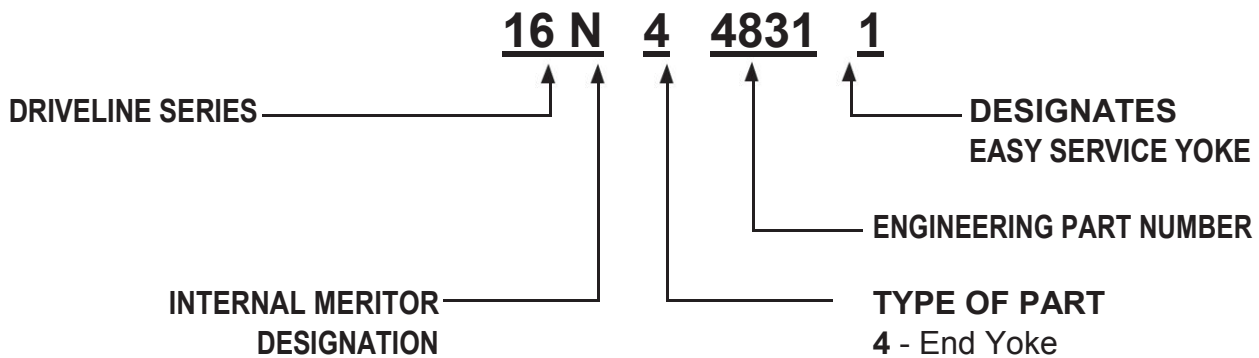

MERITOR NUMBERING SYSTEM

WELD YOKE

Meritor components may be identified by one of the numbering systems shown below.

Aftermarket numbers are issued to make Meritor components easy to select when choosing a replacement component.

MERITOR ENGINEERING NUMBER

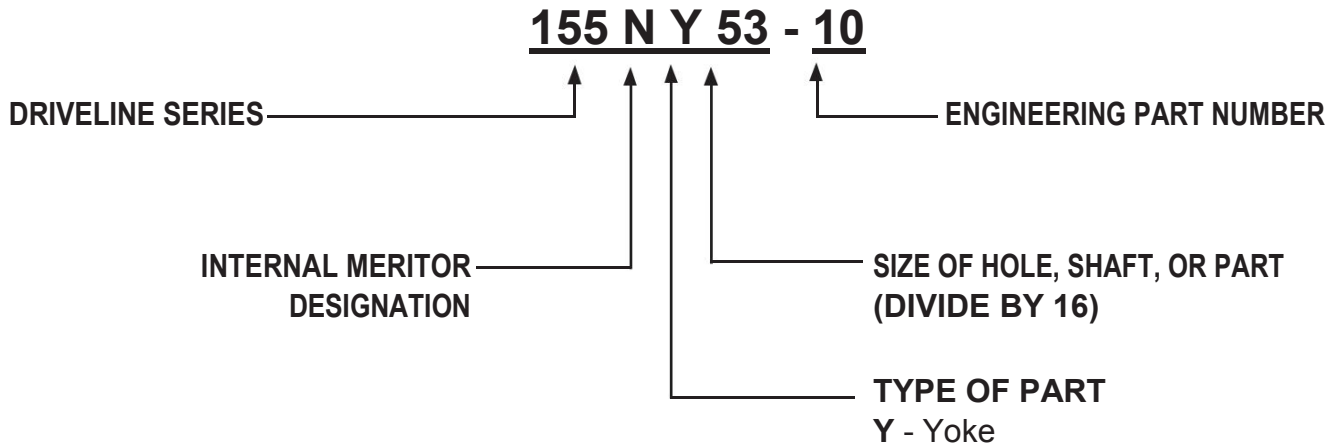

MERITOR AFTERMARKET NUMBER

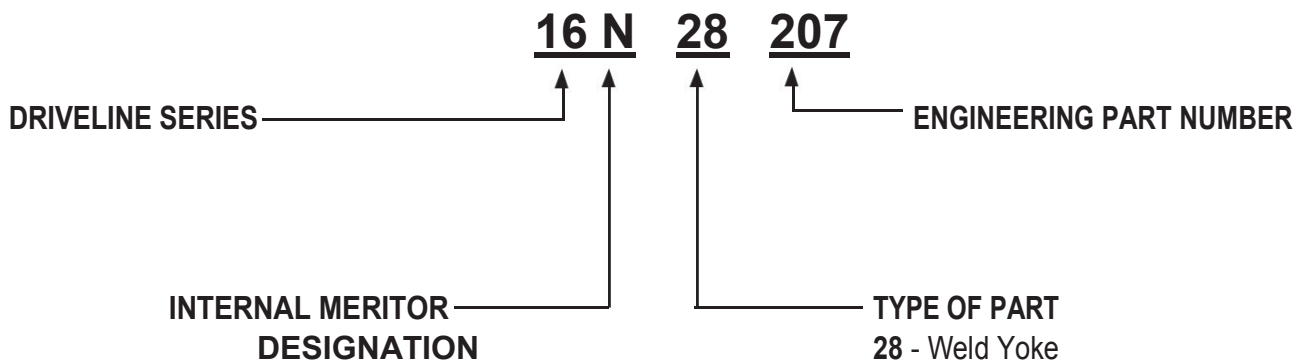

MERITOR NUMBERING SYSTEM

BEARING STUBS AND SPLINE PLUGS

Meritor components may be identified by one of the numbering systems shown below.

Aftermarket numbers are issued to make Meritor components easy to select when choosing a replacement component.

MERITOR ENGINEERING NUMBER

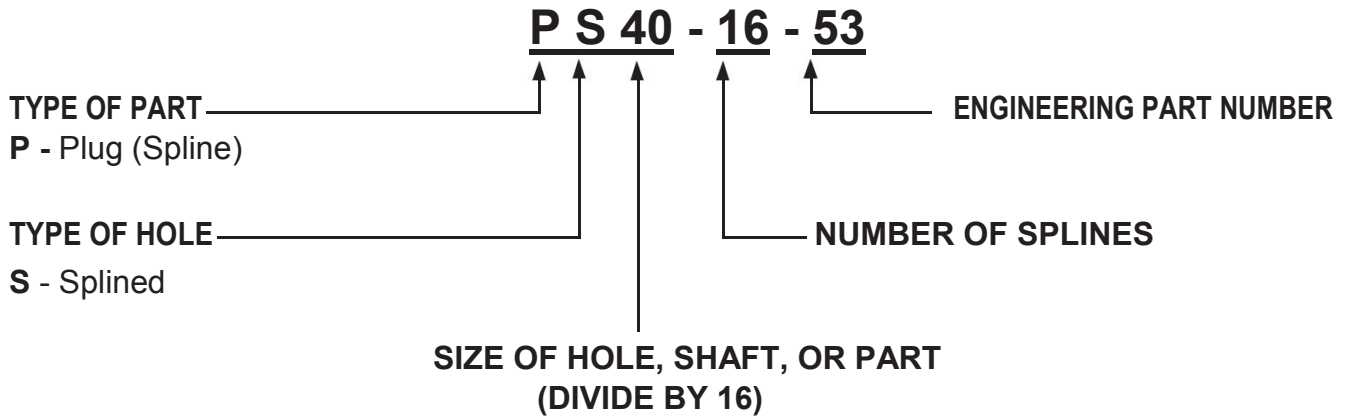

MERITOR AFTERMARKET NUMBER

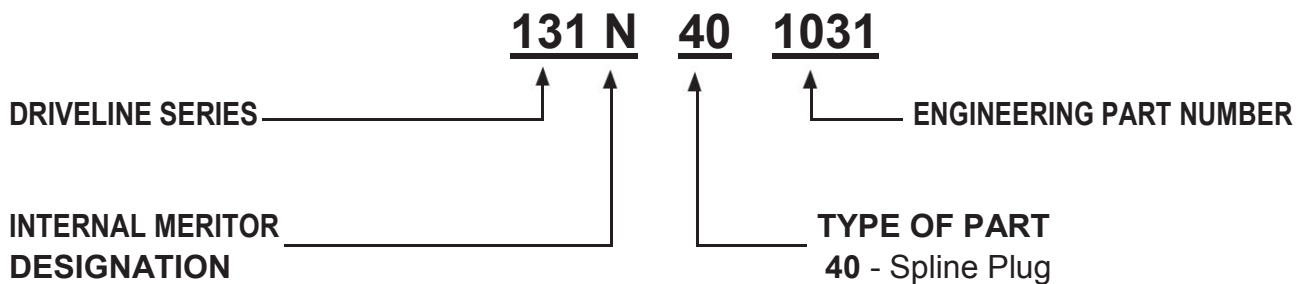

MERITOR NUMBERING SYSTEM

SHAFT YOKE

Meritor components may be identified by one of the numbering systems shown below.

Aftermarket numbers are issued to make Meritor components easy to select when choosing a replacement component.

MERITOR ENGINEERING NUMBER

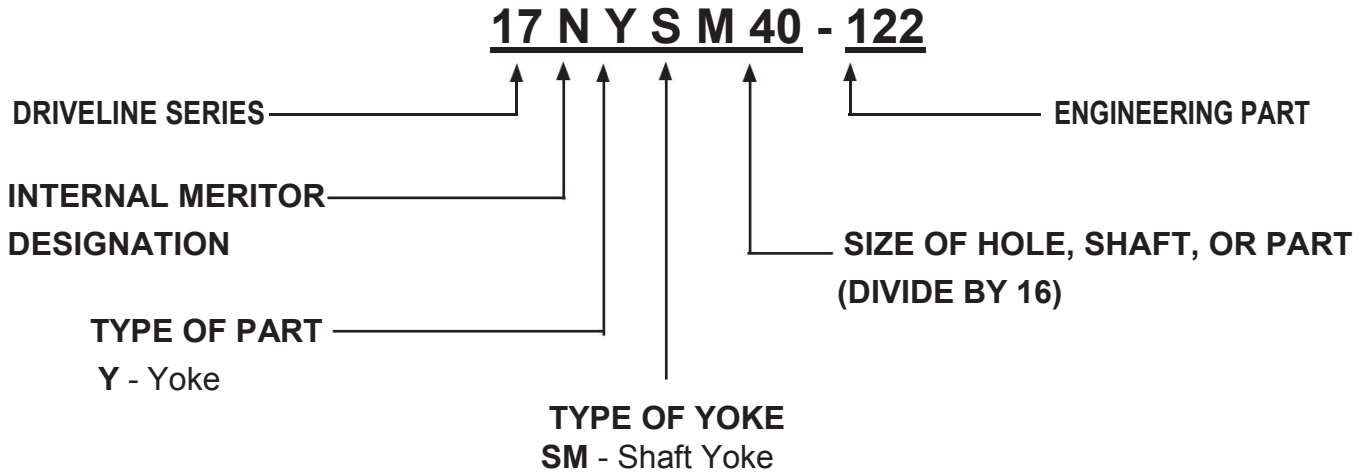

MERITOR AFTERMARKET NUMBER

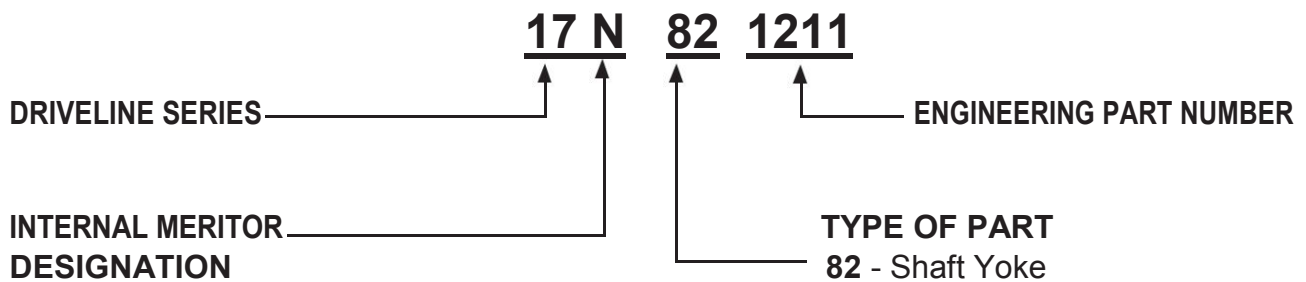

MERITOR NUMBERING SYSTEM

CLAMP AND SLIP YOKE

Meritor components may be identified by one of the numbering systems shown below.

Aftermarket numbers are issued to make Meritor components easy to select when choosing a replacement component.

MERITOR ENGINEERING NUMBER

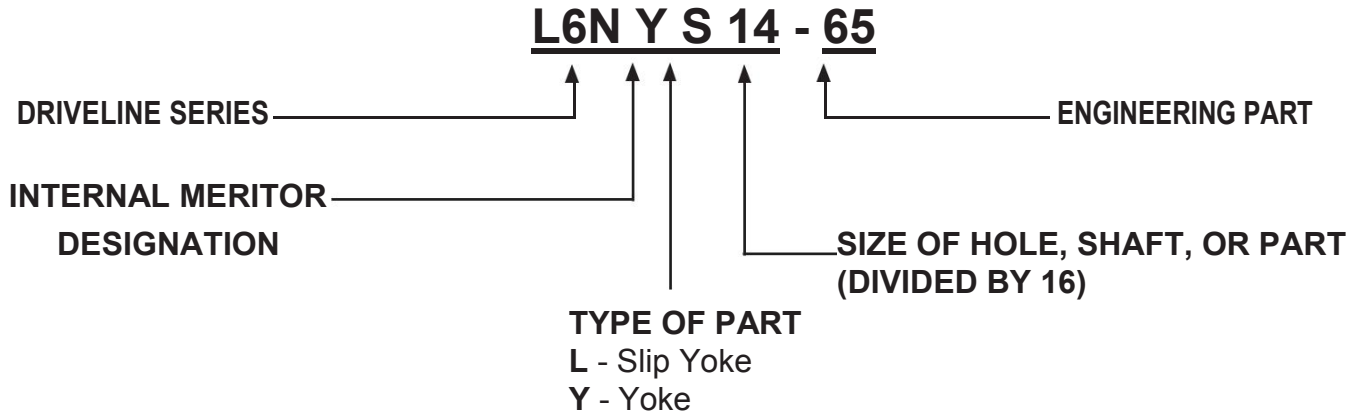

1310 SERIES

PART TYPE	COMPARISON NUMBER	MERITOR NUMBER	COMMENTS
U-Joint Kit	5-1201X	CP1201X	Full Round
	5-134X	CP134X	Full Round
	5-153X	CP153X	Full Round
	5-353X	CP353X	Full Round
Slip Yokes	2-3-128KX	131N3128KX	
	2-3-8001KX	131N38001KX	
	2-3-8021KX	131N38021KX	
Tube Shafts	2-40-1031	131N401031	
	2-40-1221	131N401221	
	2-40-1701	131N401701	
	2-40-1711	131N401711	
	2-40-1771	131N401771	
	2-40-1851	131N401851	
Flange Yoke	2-2-329	131N2329	
	2-2-479	131N2479	
	2-2-939	131N2939	
Tube Yokes	2-28-277	131N28277	
	2-28-307	131N28307	
	2-28-357	131N28357	
	2-28-367	131N28367	
	2-28-397	131N28397	
	2-28-427	131N28427	
	2-28-437	131N28437	
End Yokes	2-4-473	131N4473	
	2-4-533	131N4533	

1330 SERIES

PART TYPE	COMPARISON NUMBER	MERITOR NUMBER	COMMENTS
U-Joint Kit	5-1204X	CP1204X	Full Round
	5-134X	CP134X	Full Round
	5-213X	CP213X	Full Round
Slip Yokes	2-3-8041KX	133N38041KX	
Tube Yokes	2-28-1177	133N281177	
	2-28-1697	133N281697	
	2-28-1707	133N281707	
	2-28-1717	133N281717	

1350 SERIES

PART TYPE	COMPARISON NUMBER	MERITOR NUMBER	COMMENTS
U-Joint Kit	5-178X	CP178X	Full Round
Slip Yokes	3-3-1501KX	135N31501KX	
	3-3-488KX	135N3488KX	
	3-3-598KX	135N3598KX	
Midship Tube Shafts	3-53-1351	135N531351	
Flange Yoke	3-2-119	135N2119	
Tube Yokes	3-28-427	135N28427	
	3-28-47	135N2847	
	3-28-57	135N2857	

1410 SERIES

PART TYPE	COMPARISON NUMBER	MERITOR NUMBER	COMMENTS
U-Joint Kit	5-160X	CP160X	Full Round
Slip Yokes	3-3-118KX	141N3118KX	
	3-3-508KX	141N3508KX	
Midship Tube Shafts	3-53-1361	141N531361	
Flange Yoke	3-2-159	141N2159	
	3-2-429	141N2429	
Tube Yokes	3-28-367	141N28367	
	3-28-97	141N2897	
End Yokes	3-4-1841-1	141N41841	

1480 SERIES

PART TYPE	COMPARISON NUMBER	MERITOR NUMBER	COMMENTS
U-Joint Kit	5-188X	CP188X	Full Round
Slip Yokes	3-3-1601KX	148N31601KX	LD & MD Driveshaft Style
Flange Yoke	3-2-479	148N2479	Snap Ring Design
Tube Yokes	3-28-537	148N28537	
	3-28-567	148N28567	

1550 SERIES

PART TYPE	COMPARISON NUMBER	MERITOR NUMBER	COMMENTS
U-Joint Kit	5-155X	CP155N	Full Round
Slip Yokes	4-3-1241KX	155N31241X	LD & MD Driveshaft Style
Flange Yoke	4-2-669	155N2669	Snap Ring Design
Tube Shafts	4-40-721	155N40721	

1610 SERIES

PART TYPE	COMPARISON NUMBER	MERITOR NUMBER	COMMENTS
U-Joint Kit	5-279X	M279X	Full Round
	5-674X	M674X	Half Round
Slip Yokes	5-3-2261KX	16N32261XML	HD Driveshaft Style
	5-3-288KX	16N3288XML	HD Driveshaft Style
Tube Shafts	5-40-1011	16N401011	
Midship Tube Shafts	5-53-141	16N53141	Outboard Slip Yokes
Flange Yoke	5-2-279	16N2279	Bearing Plate Design
	5-2-629	16N2629	Bearing Plate Design
Tube Yokes	5-28-627	16N28627	
End Yokes	5-4-1721	16N41721	
	5-4-4441X	16N44441X	
	5-4-4451X	16N44451X	
	5-4-4841-1X	16N448411X	
	5-4-6251	16N46251	
	5-4-6321-1	16N463211	
		16NYS38-12A	
		16TYS32-76	
	16TYS32-76A		
Deflector/Slinger	98-1361	2847Z312	
	98-1362	DEFR472	
Bearing Strap Kit	5-70-28X	KT16SB	

To maintain product integrity, it is essential that Genuine Meritor bolts or screws are used to replace ANY removed when inspecting OR during installation of a NEW 1610 MXL Universal Joint (hardware included with NEW kits).

Full Round: Cap Screws (Part No. S155B2) x 8

Half Round: Cap Screws (Part No. S155B2) x 4 & Bearing Strap Kit (Part No. KT16SB) x 1

1710 SERIES

PART TYPE	COMPARISON NUMBER	MERITOR NUMBER	COMMENTS
U-Joint Kit	5-280X	M280X	Full Round
	5-675X	M675X	Half Round
Slip Yokes	6-3-2671KX	17N-3-2671X-MXL	
	6-3-2651KX	17N-3-2651X-MXL	HD Driveshaft Style
	6-3-3441KX	17N32401XML	HD Driveshaft Style
Slip & Stub Assembly	6-3-2651KX	17N-3-2651X-MXL	HD Driveshaft Style
	6-40-521	17N40521	

1710 SERIES - CONT'D

PART TYPE	COMPARISON NUMBER	MERITOR NUMBER	COMMENTS
Tube Shafts	6-40-521	17N40521	
	6-40-541	17N40541	
Midship Tube Shafts	6-53-201	17N53201	Companion Flange or End Yoke Design
	6-53-311	17N53311	Companion Flange or End Yoke Design
Flange Yoke	6-2-749	17NF1	Bearing Plate Design
Tube Yokes	6-28-137	17N28137	
	6-28-347	17N28347	
	20.74.91	1227Z936	
Yoke Shafts	6-82-1091-12	17N8211712	
End Yokes	6-4-1981	17N41981	
	6-4-1991	17N41991	
	6-4-1471	17N42271	
	6-4-2381	17N42381	
	6-4-3221	17N43221	
	6-4-3241	17N43241	
	6-4-3291	17N43291	
	6-4-4091	17N44091	
	6-4-4291X	17N44291X	
	6-4-4301X	17N44301X	
	6-4-4361X	17N44361X	
	6-4-4481X	17N44481X	
	6-4-4551	17N44551	
	6-4-4601	17N44601	
	6-4-4741X	17N44741X	
	6-4-4771-1	17N447711	
	6-4-5061X	17N45061X	
	6-4-5451	17N45451	
	6-4-5461X	17N45461X	
	6-4-5481X	17N45481X	
	6-4-5501	17N45501	
	6-4-5521	17N45521	
	6-4-5961X	17N45961X	
	6-4-6021X	17N46021X	
	06-04-21	17N46321	
	6-4-6331	17N46331	
	6-4-6391-1X	17N463911X	
	6-4-6391X	17N46391X	
	6-4-5101X	17N46411X	
	6-4-6421X	17N46421X	
	6-4-6451	17N46451	
	6-4-6481	17N46481	

1710 SERIES - CONT'D

PART TYPE	COMPARISON NUMBER	MERITOR NUMBER	COMMENTS
End Yokes	6-4-6871X	17N46871X	
	6-4-6891X	17N46891X	
	6-4-6921X	17N46921X	
	6-4-6931X	17N46931X	
	6-4-6941X	17N46941X	
	6-4-6951X	17N46951X	
	6-4-6961-1X	17N469611X	
	6-4-6961X	17N46961X	
	6-4-7181-1X	17N471811X	
	6-4-7181X	17N47181X	
	6-4-7541	17N47541	
	6-4-7621-1	17N476211	
	6-4-7641-1X	17N476411X	
	6-4-7851X	17N47851X	
	6-4-8511X	17NYS2866A	
	6-4-8531X	17N48531X	
	6-4-8551X	17N48551X	
	6-4-9001X	17N49001X	
	6-4-9031X	17N49031X	
	6-4-9041X	17N49041X	
	6-4-6401	17NYS32-100	
	6-4-4971	17NYS32-99	
	6-4-6381X	17NYS32-99A	
	6-4-7651X	17NYS3418A1	
	6-4-9181X	17NYS3419A1	
		17NYS34-20	
		17NYS38-17A2	
	6-4-7771X	17N47771X	
	6-4-8331-1X	17TYS3260A	
	6-4-1981-1	17TYSC3154	
6-4-4601-1	17N446011		
Deflector/Slinger	231616	DEFR621	
Bearing Strap Kit	6.5-70-18X	KT17SB	

To maintain product integrity, it is essential that Genuine Meritor bolts or screws are used to replace ANY removed when inspecting OR during installation of a NEW 1710 MXL Universal Joint (hardware included with NEW kits).

Full Round: Cap Screws (Part No. S165B2) x 8

Half Round: Cap Screws (Part No. S165B2) x 4 & Bearing Strap Kit (Part No. KT17SB) x 1

1760 SERIES

PART TYPE	COMPARISON NUMBER	MERITOR NUMBER	COMMENTS
U-Joint Kit	5-677X	M677X	Half Round
	5-407X	M407X	Full Round
End Yokes	6.3-4-331-1X	176N43311X	
	6.3-4-181X	176N4181X	
	6.3-4-1031	176NYS38-14	
	6.3-4-781-1X	176N47811X	
Bearing Strap Kit	6.5-70-18X	KT17SB	

To maintain product integrity, it is essential that Genuine Meritor bolts or screws are used to replace ANY removed when inspecting OR during installation of a NEW 1760 MXL Universal Joint (hardware included with NEW kits).

Full Round: Cap Screws (Part No. S165B2) x 8

Half Round: Cap Screws (Part No. S165B2) x 4 & Bearing Strap Kit (Part No. KT17SB) x 1

1810 SERIES

PART TYPE	COMPARISON NUMBER	MERITOR NUMBER	COMMENTS
U-Joint Kit	5-324X	CP18N-96	Conversion - 9C Series
	5-281X	M281X	Full Round
	5-676X	M676X	Half Round
Weld Yoke	6.5-28-117	18N28117	Standard
	6.5-28-127	18N28127	Heavy Duty
Splined End Yokes	6.5-4-2341X	18N42341X	
	6.5-4-2701	18N42701	SSHD Late
	6.5-4-2781	18N42781	
	6.5-4-3201	18N43201	RT180-185-380
	6.5-4-3021	18N43021	Eaton / Spicer
	6.5-4-3251	18N43251	VARIOUS
	6.5-4-3371	18N43371	RT140
	6.5-4-3491	18N43491	RT14613/14615/14715/15613/14615/16718B/16609/16613/16618/18718B And various other models with 3.750" Hub Seal
	6.5-4-3721	18NYS3827	
6.5-4-4631	18NYS45	RT14/15/16/18/20 SERIES	
Slip Yokes	6.5-3-1351KX	18N31351X-MXL	
	6.5-3-1371KX	18N31371XMXL	
	6.5-3-1431KX	18N31431X	
Slip & Stub Assembly	6.5-3-1371KX	18N31371XMXL	Combined Meritor Part Number 18NSLIP
		18N40191	
Midship Tube Shafts	6.5-53-51	18N5351	
	8-53-41	BSS3610	
	6.5-53-171	18N53171	
	6.5-53-91	18N5391	
Tube Shafts	8-40-91	PS481619	Long

1810 SERIES - CONT'D

PART TYPE	COMPARISON NUMBER	MERITOR NUMBER	COMMENTS
Stub	6.5-40-191	18N40191	Long Male
	6.5-40-201	18N40201	Standard Male
Slinger	6.5-4-3221X	18N43221X	
	6.5-4-3281X	18N43281X	
	6.5-4-2491X	18N43381X	
	6.5-4-3551X	18N43551X	
	6.5-4-3561X	18N43561X	
	6.5-4-3581X	18N43581X	
	6.5-4-3731X	18N43731X	
	6.5-4-3921X	18N43921X	
End Yokes	6.5-4-1891	18N41891	Full Round
	6.5-4-1891-1	18N418911	Half Round
	6.5-4-2361X	18N42361X	Full Round
	6.5-4-2531X	18N42531X	
	6.5-4-2271X	18N42271X	
	6.5-4-2711X	18N42711X	Splined Holes
	6.5-4-3021	18N43021	SP2.635-20B
	6.5-4-3201-1	18N432011	Half Round
	6.4-3221-1X	18N432211X	
	6.5-4-3441	18NYS38-15	Full Round
End Yokes	6.5-4-3491-1	18N434911	Half Round
	6.5-4-3561-1X	18N435611X	Half Round
	6.5-4-3591-1	18N435911	
	6.5-4-3691X	18N43691X	
	6-5-4-3731-1X	18TYS3827A	Half Round
	6.5-4-4351X	18N44351X	SP2.274-44B
	6.5-4-4571X	18NYS3620A	
	6-5-4-4571-1X	18N445711X	Half Round
	6.5-4-4611X	18N44611X	
		18N439211X	2.390-46IN 6.0HR
Bearing Strap Kit	6.5-70-18X	KT17SB	

To maintain product integrity, it is essential that Genuine Meritor bolts or screws are used to replace ANY removed when inspecting OR during installation of a NEW 1810 MXL Universal Joint (hardware included with NEW kits).

Full Round: Cap Screws (Part No. S165B2) x 8

Half Round: Cap Screws (Part No. S165B2) x 4 & Bearing Strap Kit (Part No. KT17SB) x 1

SPL 170 SERIES

PART TYPE	COMPARISON NUMBER	MERITOR NUMBER	COMMENTS
U-Joint Kit	SPL170-3X	US170X	SPL170
End Yokes	170-4-591-1X	170TYS383A1	SPL 170
	170-4-611-1X	170TYS381A	SPL 170
	170-4-661-1	170TYS321	SPL 170
	170-4-671-1X	170TYS321A	SPL 170
	170-4-721-1X	170TYS384A	SPL 170
	170-4-741-1X	170TYS382A	SPL 170
	170-28-27	170N2827	SPL 170 Quick Disconnect

SPL 250 SERIES

PART TYPE	COMPARISON NUMBER	MERITOR NUMBER	COMMENTS
U-Joint Kit	SPL 250-3X	US250X	SPL 250
End Yokes	250-4-21-1	250N4211	SPL 250 Quick Disconnect
	250-4-271-1	250N42711	SPL 250
	250-4-351-1X	250TYS382A	SPL 250
	250-4-291-1X	250TYS381A	SPL 250
	250-28-17	250N2817	Weld Yoke SPL 250

RPL 20R SERIES

PART TYPE	COMPARISON NUMBER	MERITOR NUMBER	COMMENTS
U-Joint Kit		CP20RPLS	RPL20 Series
End Yokes		20WYS328A	2.00"- 39 Spline
		20WYS32-17	2"- 39 Spline
		20WYS32-6A	2"- 39 Spline
		20WYS32-2P	2"- 39 Spline
		20WYS34-4A	2.13"- 41 Spline
		20WYS38-11A	2.38"- 46 Spline
		20WYS38-3A	2.38"- 46 Spline
		20WYS38-4A	2.38"- 46 Spline
		20WYS38-8A	2.38"- 46 Spline
		20WYS40-2A	2.50"- 10 Spline
		20WYS44-2A	2.75"- 10 Spline
Patch Bolts		20WYS45	2.79"- 54 Spline
		CSC82052	refer comments below

To maintain product integrity, it is essential that Genuine Meritor bolts or screws are used to replace ANY removed when inspecting OR during installation of a NEW Meritor RPL Universal Joint (RPL20R or RPL25R).

Patch Lock Bolts (Part No. CSC82052) X 4

RPL 25R SERIES

PART TYPE	COMPARISON NUMBER	MERITOR NUMBER	COMMENTS
U-Joint Kit		CP25RPLS1	RPL 25 Series
End Yokes		25RY68-3KHP	Weld Yoke
		25WYS36-1A	2.28"- 44 Spline
		25WYS38-13A	2.38"- 46 Spline
		25WYS38-6A	2.38"- 46 Spline
		25WYS38-8A	2.38"- 46 Spline
		25WYS44-2A	2.75"- 10 Spline
		25WYS45	2.79"- 54 Spline
		25WYSC38-11	2.38"- 46 Spline
		25WYS38-9A1X	2.38"- 46 Spline
Patch Bolts		CSC82052	refer comments below
Slip Yokes		25RLS481A1S	
		25RPLSLIP	

To maintain product integrity, it is essential that Genuine Meritor bolts or screws are used to replace ANY removed when inspecting OR during installation of a NEW Meritor RPL Universal Joint (RPL20R or RPL25R).

Patch Lock Bolts (Part No. CSC82052) X 4

MERITOR RPL OPTION YOKE REFERENCE AND TRANSMISSION

CARRIER	YOKE TYPE
RT140/145 Forward	
25WYS38-13A	Forward Input Yoke
20WYS32-2P	Output Yoke
RT140/145 Rear	
20WYS32-2A	Rear Input Yoke
RT160 Forward	
25WYS38-13A	Forward Input Yoke
20WYS32-2P	Output Yoke
RT160 Rear	
20WYS38-3A	Rear Input Yoke
RT180/185 & 380 Forward	
25WYS38-8A	Forward Input Yoke
20WYS32-2P	Output Yoke
RT180/185 Rear	
20WYS38-8A	Rear Input Yoke
RT380 Rear	
20WYS32-2A2	Rear Input Yoke
TRANSMISSION	YOKE TYPE
RTLO18718	
25WYS44-2A	10 Spline Output
RTLO22918	
25WYS45	54 Spline Output

CENTRE BEARINGS

PART TYPE	COMPARISON NUMBER	MERITOR NUMBER	COMMENTS
Bearing Centre Assy Rub	210088-1X	CB2100881X	1310/1330/1350/1410
Bearing Centre 141N	210391-1X	CB2103911X	1410/1480/1550/1550HR
Bearing Centre 141N	210433-1X	CB2104331X	1410/1480/1550/1550HR
Centre Assy	210084-2X	CB2100842X	1480/1550/1610/1710/1880/SPL70
Bearing Centre 17N	210121-1XB	CB2101211XSA	SPL140/1610/1710
Bearing Centre Slotted	5003323XB	CB2106611XSA	RPL25
Bearing Centre Slotted	210661-1X	CB2106611XSA	1760/1710/1810
Bearing Centre Solid	5003326XB	CB2108751XSA	RPL25/176N/17N/18N/85WB/92N/ RPL25
Bearing Centre Solid	210875-1X	CB2108751XSA	176N/18N

UNIVERSAL JOINTS - MERITOR

PART TYPE	COMPARISON NUMBER	MERITOR NUMBER	COMMENTS
U-Joint Kit		CP18S3P3	
		CP58WB29.1P3	58WB Series
		CP58WB37.1P3	58WB Series
		CP58WB38.1P3	58WB Series
		CP58WBDWT	58WB Series
		CP58WBHB	58WB Series
	5-6000X	CP62N47P3	62N Series
		CP62N48P3	62N Series
		CP62N49P3	62N Series
		CP62N78P3	62N Series
		CP72N116P3	72N Series
		CP72N121P3	72N Series
		CP72N165P3	72N Series
		CP72N90P3	72N Series
		CP72NDWT	72N Series
		CP82N72.1P3	82N Series
		CP82N76.1P3	82N Series
		CP82N90P3	82N Series
		CP82NHWDPL	82N Series
		CP850N4	850N Series
		CP85WB48P3	85WB Series
		CP85WB62P3	85WB Series
		CP85WB73P3	85WB Series
		CP85WBHWD	85WB Series
		CP92N106P3	92N Series
		CP92N115P3	92N Series
		CP92N66	92N Series
		CP92N66P3	92N Series
		CP92N71P3	92N Series
		CP92N72P3	92N Series
		CP92N73P3	92N Series
		CP92NDWT	92N Series
		CP92NHBPL	92N Series
		CP92N115P3	92N Series
		MCP380	Volvo
		MCP381	Volvo
		CP750N1	750N Series
		CPL15N1S	L15 Series

UNIVERSAL JOINTS - DANA

PART TYPE	COMPARISON NUMBER	MERITOR NUMBER	COMMENTS
U-Joint Kit	5-3147X	CP3147X	3R Series
	5-92X	CPL6R50	L6 Series
	5-105X	CP105X	1110 Series
	5-1306X	CP1306X	7260
	5-170X	CP103X	1000
	5-9001X	CP92NHWD	9C/1820
		CP950N	950N

FAST MOVING UNIVERSAL JOINTS

PART TYPE	COMPARISON NUMBER	MERITOR NUMBER	COMMENTS
U-Joint Kit	5-279X	M279X	Full Round
	5-674X	M674X	Half Round
	5-280X	M280X	Full Round
	5-675X	M675X	Half Round
	5-677X	M677X	Half Round
	5-407X	M407X	Full Round
	5-281X	M281X	Full Round
	5-676X	M676X	Half Round

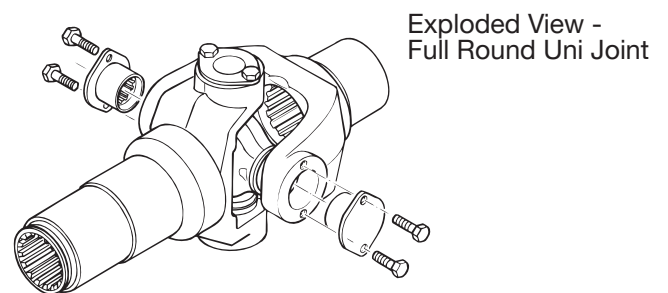
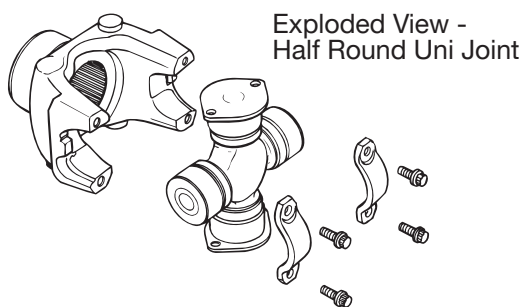

END YOKES PARTS FOR MERITOR DRIVE AXLES

140/145 FORWARD CARRIERS

DESCRIPTION	AFTERMARKET NUMBER
Yoke Input 1810 Full Round (2.39 -46 SPLINE,LARGE SHAFT)	18N43731X
Yoke Input 1810 Half Round (2.39 -46 SPLINE,LARGE SHAFT)	18TYS3827A
Yoke Input 1710 Full Round (2.39 -46 SPLINE,LARGE SHAFT)	17N47181X
Yoke Input 1710 Half Round (2.39 -46 SPLINE,LARGE SHAFT)	17N471811X
Yoke Input 1810 Full Round (2.00 -39 SPLINE,SMALL SHAFT)	18N43381X
Yoke Input 1810 Half Round (2.00 -39 SPLINE,SMALL SHAFT)	18N433711
Yoke Input 1710 Full Round (2.00 -39 SPLINE,SMALL SHAFT)	17N46411X
Yoke Output 1710 Full Round (2.00 -39 SPLINE,SMALL SHAFT)	17NYS3299

140/145 REAR CARRIERS

DESCRIPTION	AFTERMARKET NUMBER
Yoke Input 1710 Full Round	17N46391X

160 FORWARD CARRIERS

DESCRIPTION	AFTERMARKET NUMBER
Yoke Input 1810 Full Round	18N43731X
Yoke Input 1810 Half Round	18TYS3827A
Yoke Output 1710 Full Round	17NYS3299

160 REAR CARRIERS

DESCRIPTION	AFTERMARKET NUMBER
Yoke Input 1710 Full Round	17NYS3838A
Yoke Input 1710 Half Round	17N471811X

180/185 & 380 FORWARD CARRIERS

DESCRIPTION	AFTERMARKET NUMBER
Yoke Input 1810 Full Round	18N43221X
Yoke Input 1810T Half Round	18N432211X
Yoke Output 1710 Full Round	17NYS3299

180/185 & 380 REAR CARRIERS

DESCRIPTION	AFTERMARKET NUMBER
Yoke Input 1710 Full Round	17N47851X
Yoke Input 1810 Full Round	18N43581X

DRIVELINE COMPONENTS

t

SERVICE U-JOINT KITS

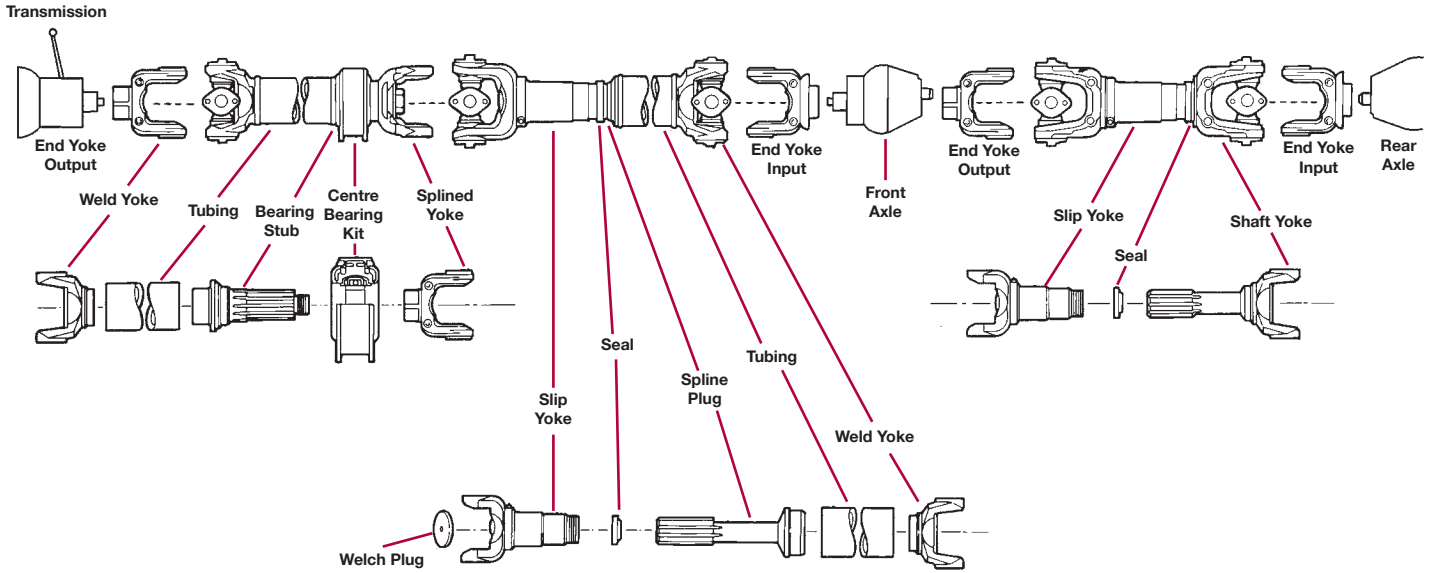

STRAP & BOLT KITS:

- KT16SB
- KT17SB

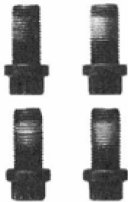

- KT122
- KT124

U-BOLT KITS:

- KT116
- KT117
- KT118

MISCELLANEOUS

PART TYPE	COMPARISON NUMBER	MERITOR NUMBER	COMMENTS
Deflector Yoke		DEFR404	52N
	231022	DEFR485	1610/1710/1760/1810
	230909	DEFR421	SPL90/1410/1480/1550/1610/1650/1710
	231028	DEFR482	1550/1610/1710/1760/1810
	231599	DEFR4713	SPL140/1610/1710/1810
	231101	DEFR477	SPL140/1610/1710
	231102	DEFR504	SPL170/1610/1710
	231359	DEFR507	SPL90/SPL140/SPL170/1550/1610/1710/
	231179	DEFR541	SPL170/SPL250/1610/1710/1460/1810/
	231013	DEFR552	1610/1710/1760/1810/
	231047	DEFR562	1760/1810
	231803	DEFR567	SPL90/SPL140/SPL170/SPL250/1610/1710/1810
		DEFR591	
		DEFR592	
Deflector Yoke RPL 20		DEFR64	RPL 20R
		DEFR534	
Dust Caps/Yoke	6.3-8618	SERUR334	
Seal Dust		SERUR32-7	RPL 20R
Seal Dust		SERUR40-21	RPL 25R
End Yoke		92NYS3227	92N
End Yoke		92NYS3869	92N
Flange Assembly FUI 180/150 PCD KV70		Z3260F1072	
Hardware Kit	5007417	R980001	SPL140/SPL170/SPL250
Kit Strap & Capscrew	3-70-28X	KT122	1350/1410
Kit Service	6-5-70-18X	KT17SB	1710/1810
Kit Dust Cap/Wshr 1350/1410 RD	D3A	ND3A	1350/1410
Kit Dust Cap/Wshr 1410/1480 RD	D3H	DC148N1	1410/1480
Locknut	231502	1227Z936	1550/1610/1650/SPL90/1710/1760/1810/1880
Round Tubing	36-30-102-10000	RT4597108	
Screw Cap	5-73-109	S155B2	1610
Screw Cap	6-73-209	S165B2	1710/1760/1810
Slinger - CTR/BRG 3.312 I.D	230746	DEFR551	1710/1810
Slip Yoke 9C 3" 16		92NLS4847DC	92N

MISCELLANEOUS - CONT'D

PART TYPE	COMPARISON NUMBER	MERITOR NUMBER	COMMENTS
Slip Yoke Assy WNG BRNG 72N		72NLS32142A	72N
Slip Yoke Assy WNG BRNG 72N		72NLS3220DC	72N
Slip Yoke Assy WNG BRNG 92N		92NLS4866A	92N
Strap	250.70.18X	250N7018X	SPL250
Strap	3-70-99	REBC1482	1480/1550
Strap Retainer		REBC17S	1760/1710/1810
Tube Shaft - 3.000 -16SP 11.531	8-40-101	PS481616	1810/1880
U-Bolt Kit - 1260/1330 U/Joint	2-94-28X	KT116	1210/1310/1330 - 2 U-bolts and 4 Nuts each
U-Bolt Kit - 1350/1410 U/Joint	3-94-18X	KT117	1350/1410
U-Bolt Kit -1480/1550 U/Joint	3-94-28X	KT118	1480/1550
Washer - Special	230123-6	WAR211	1710/HD/1760/1810/SPL70/SPL100/ SPL140/SPL170/SPL250/1810 BP
Weld Yoke WNG BRNG 72N		72NYS220	
Yoke		L6NYS1331	
End Yoke		92NYS3225	
Yoke Shaft		950NYSM381	
Yoke & Deflector Assy		92NYS38-52A	
Yoke Steering		L6NYS14-100	

NOTES

A large rectangular area with horizontal dotted lines, intended for writing notes. The lines are evenly spaced and extend across the width of the page.

NOTES

A large rectangular area with horizontal dotted lines, intended for writing notes. The lines are evenly spaced and extend across the width of the page.



Meritor Heavy Vehicle Systems Australia
50 Calarco Drive
Derrimut VIC 3026
AUSTRALIA

(03) 8353 6050

meritorpartsexpress.com

CMQRG002 - DRIVELINE QUICK REFERENCE GUIDE 0224
Produced in AUS 02/24
©2024 Cummins Inc.