

BULLS EYE 2020



AFTERMARKET

AUG 2020

IN THIS ISSUE:

CLICK ON THE TITLE BELOW
TO BE SENT TO THE SPECIFIC
SUBJECT IN THIS ISSUE

- [SPECIAL NOTICE](#)
- [PRODUCT IN FOCUS](#)
- [NEW PRODUCTS](#)
- [TECH TIPS](#)



MERITOR[®]
RUN WITH THE BULL

BULLS EYE 2020



SPECIAL NOTICE CHIEF SAFETY OFFICER AWARD

2019 Winners – Sunshine and Derrimut

- Sunshine achieved 943 days without an injury
- Derrimut achieved 2,655 days without an injury
- Key success factors in creating a safer workplace:
 - Proactive approach
 - Active and meaningful employee involvement



BULLS EYE 2020



SPECIAL NOTICE STOCKTAKE - WE ARE STILL OPERATING

We wish to advise that Meritor Aftermarket will be undertaking **stocktake on 17th and 18th of September 2020.**

Please take note of the following dates and information:

- **All returns should arrive at Meritor no later than Friday 11th of September 2020**
- **Parts Store will be closed from 12:00pm on Wednesday 16th September 2020**
- **Parts Store will re-open at 8:00am on Monday 21st September 2020**
- **Only price and stock check enquiries will be accepted during the stocktake closure. Technical support staff will be limited.**
- **Genuine VOR (Vehicle Off Road) cut-off date is Wednesday 16th of September at 10 am. No VOR orders will be processed during the stocktake period.**

We would like to take this opportunity to thank you for your cooperation in this matter.

Warm regards,

Meritor Aftermarket Team



BULLS EYE 2020



PRODUCT IN FOCUS NEW MERITOR PREMIUM PADS

MERITOR® MAX PREMIUM BRAKE PADS

Meritor is the global leader in brakes for heavy duty trucks, trailers and buses. MAX pads are the newest addition to our range and represent the next step up in performance and durability from our popular MDP3000 series. Tested to far exceed ECE R90 performance requirements MAX Pads are designed specifically for those aftermarket customers who choose to run with the best. **Stock arriving in September.**

- Outstanding friction coefficient
- Reduced rotor wear
- ECE R90 approved
- Premium braking performance



Find out more



BULLS EYE 2020



NEW PRODUCTS & SUPERSESSIONS

NEW PRODUCTS

NEW PART	DESCRIPTION
3XRY68-1	YOKE WELD RPL 35

SUPERSESSIONS

OLD PART	DESCRIPTION	SUPERSESSION	APPLICATION
MCB203	BEARING CENTER SELF-ALIGNING	CB2100203XSA	RPL35
68326523	CONTINUOUS WEAR SENSOR	68326698	CALIPER REPAIR KIT, LENGTH 2200MM
68326518	CONTINUOUS WEAR SENSOR	68326693	CALIPER REPAIR KIT, 1850MM
68326514	CONTINUOUS WEAR SENSOR	68326689	CALIPER REPAIR KIT, LENGTH 120MM
68326517	CONTINUOUS WEAR SENSOR	68326692	CALIPER REPAIR KIT, LENGTH 1600MM
A13102B3850	TIE ROD ASSEMBLY	R230585	FRONT AXLE, CROSS TUBES WITH ENDS
3100Z8762	CENTRE AXLE ASSEMBLY	3100W8759	MFS 73
KIT4429	KIT DCDL SWITCH	KIT4455	14X CARRIER

All parts displayed in New Products & Supersessions will be available for immediate ordering. Lead times apply for the listed items. Not all parts are available to Independent Customers. Please contact Meritor Customer Service on (03) 8353 6050 for further information. For full list of supersessions, [CLICK HERE](#)



BULLS EYE 2020



TECH TIPS MERITOR Q PLUS™ BRAKE

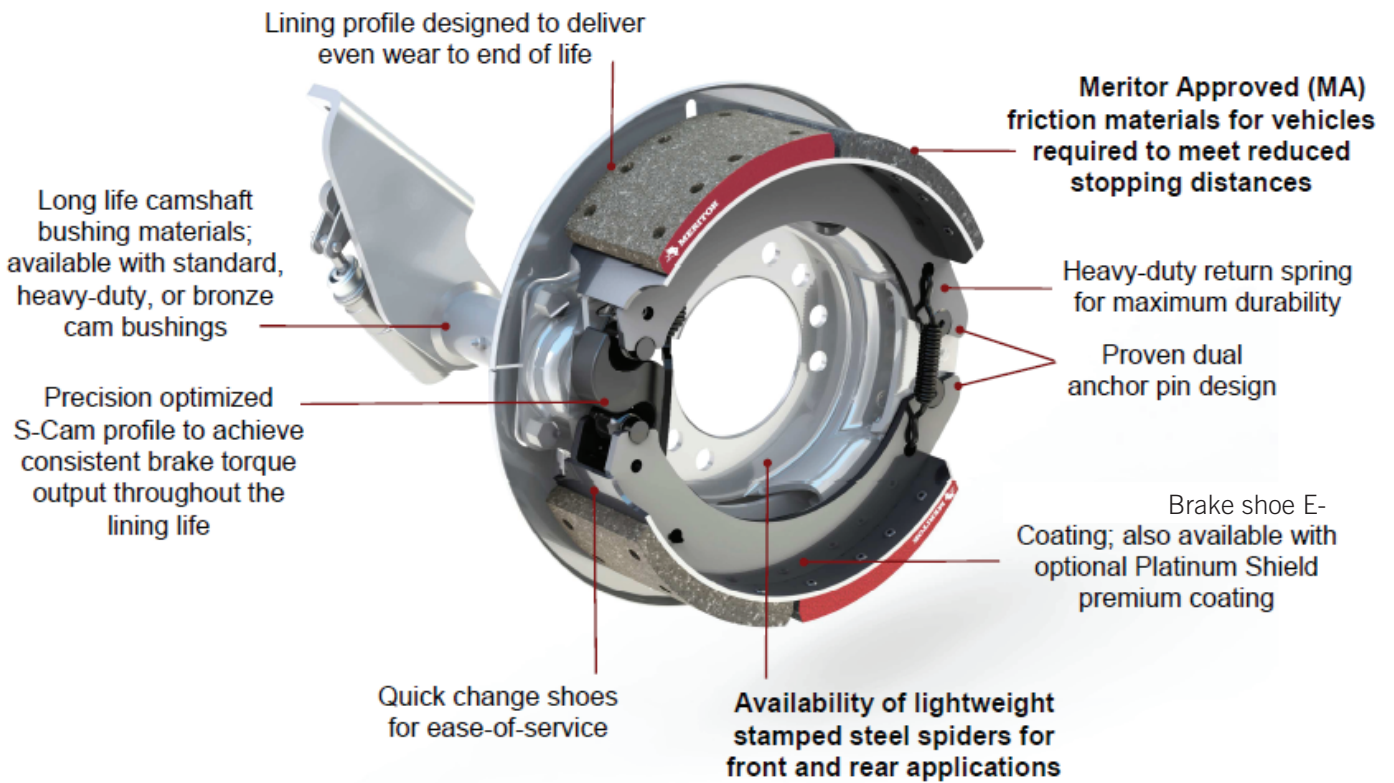

MERITOR
RUN WITH THE BULL

BULLS EYE 2020



TECH TIPS SHOE CONTACT FUNDAMENTAL

The illustration below shows a typical 16.5" diameter drum with Q-Plus shoe in a new condition. The initial contact is at the center of the shoe. By design the anchor end will be at 0.047" clearance and the cam end will be at 0.034" clearance.

NOTE: The given dimensions are nominal design.

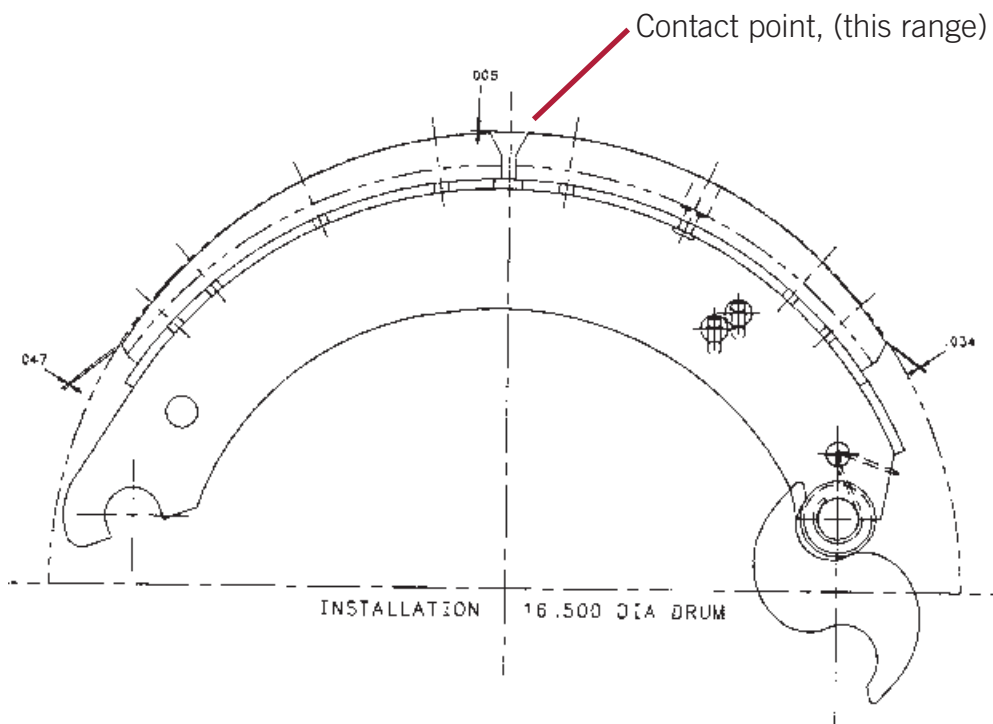

- The Q-plus shoe is designed to contact at the center of the shoe at new lining condition. This designed "crown" is necessary to control brake torque. Due to tolerance stack ups the crown is designed to contact the drum first. This condition will exist until the linings wear to the drum inside diameter over several brake applications. This is often called "bedding", "burnishing" or "green lining condition". Once the bedding is complete, a full contact of lining to drum will exist.



BULLS EYE 2020



TECH TIPS

BRAKE MAINTENANCE AND DIAGNOSTICS

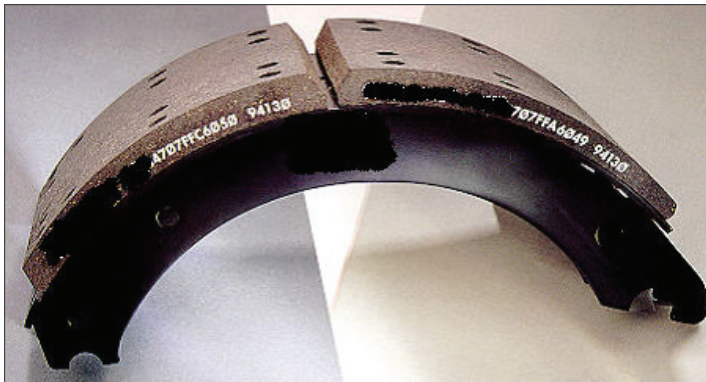

- Measure lining thickness - Minimum thickness is ¼ inch (6.3mm), 1/16 inch (2 mm) over rivets.
- Reline the brakes when the lining thickness is 0.25-inch (6.3mm) at the thinnest point.
- The rivets must not touch the drum. Damage to components will result.
- Meritor recommends that you replace the springs, rollers and anchor pins at each reline.
- Check the drum, and perform major inspection when you reline the brakes.



MERITOR
RUN WITH THE BULL



MERITOR
RUN WITH THE BULL

MERITOR HEAVY VEHICLE SYSTEMS AUSTRALIA

Meritor Commercial Vehicle Aftermarket
50 Calarco Drive, Derrimut
Melbourne - VIC 3026 - Australia

Phone: (613) 8353 6050
cvaau.sales@meritor.com
www.meritorpartsonline.com.au